

# Toledo State Hospital New Cemetery Toledo, Ohio

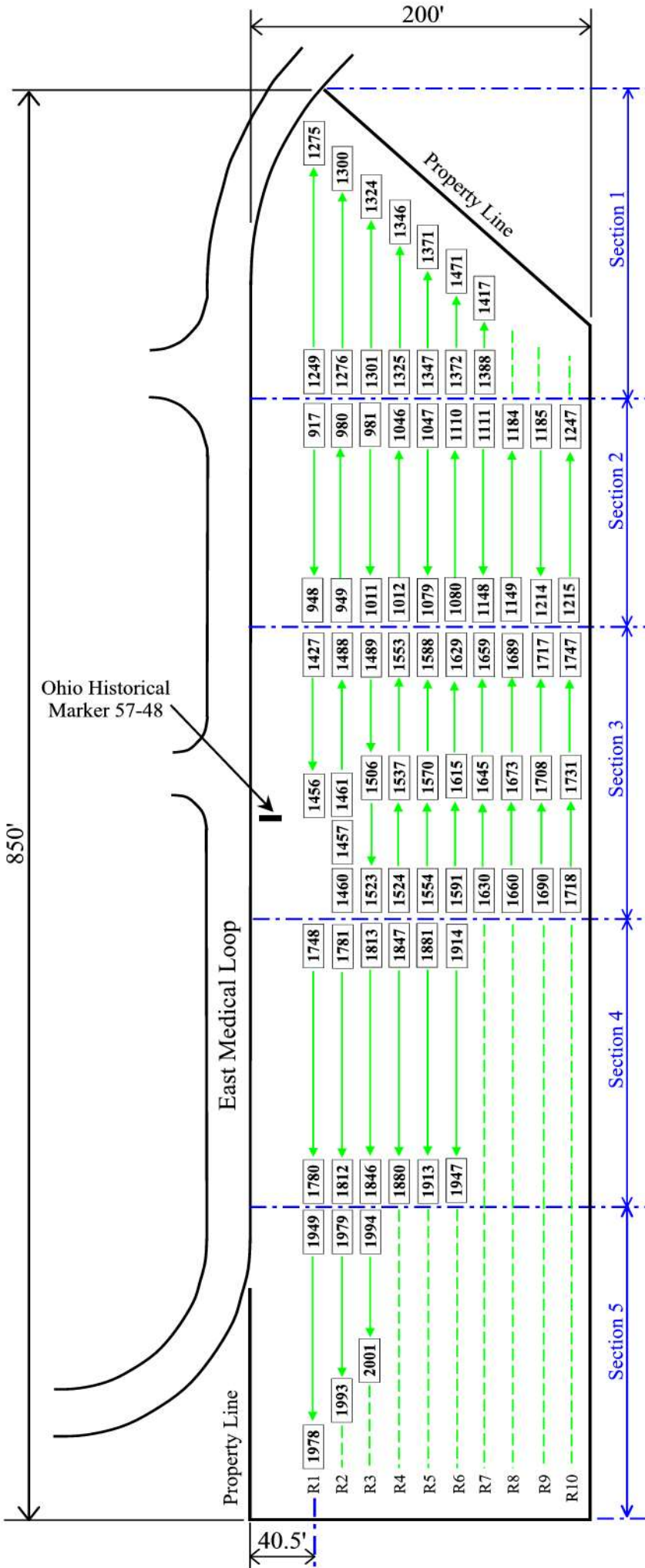
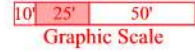

This cemetery opened in 1922 after the T.S.H. Old Cemetery on Arlington Avenue reached capacity. T.S.H. New Cemetery is the burial site of more than 1,000 individuals who died while a patient at the Toledo State Hospital.

Graves are identified by small concrete markers, each with a number corresponding to the hospital burial log that identifies each person by name.

Many of the grave markers remain unseen, buried in the grass.

The grave numbers shown on this map are those observed Fall 2020 / Spring 2021 and are for reference purposes only in their relative location.

Grave numbers are generally in their chronological position and incremental order. An exception to this is the easternmost rows of Section 1 in which the graves are somewhat mixed in their positions.

First burials were in Section 2 (Graves 917 to 1247) followed in sequence by Sections 1, 3, 4, and 5.